

# ARCHITECTS & ENGINEER SUBMITTAL SHEET

42" PRESTIGE SERIES

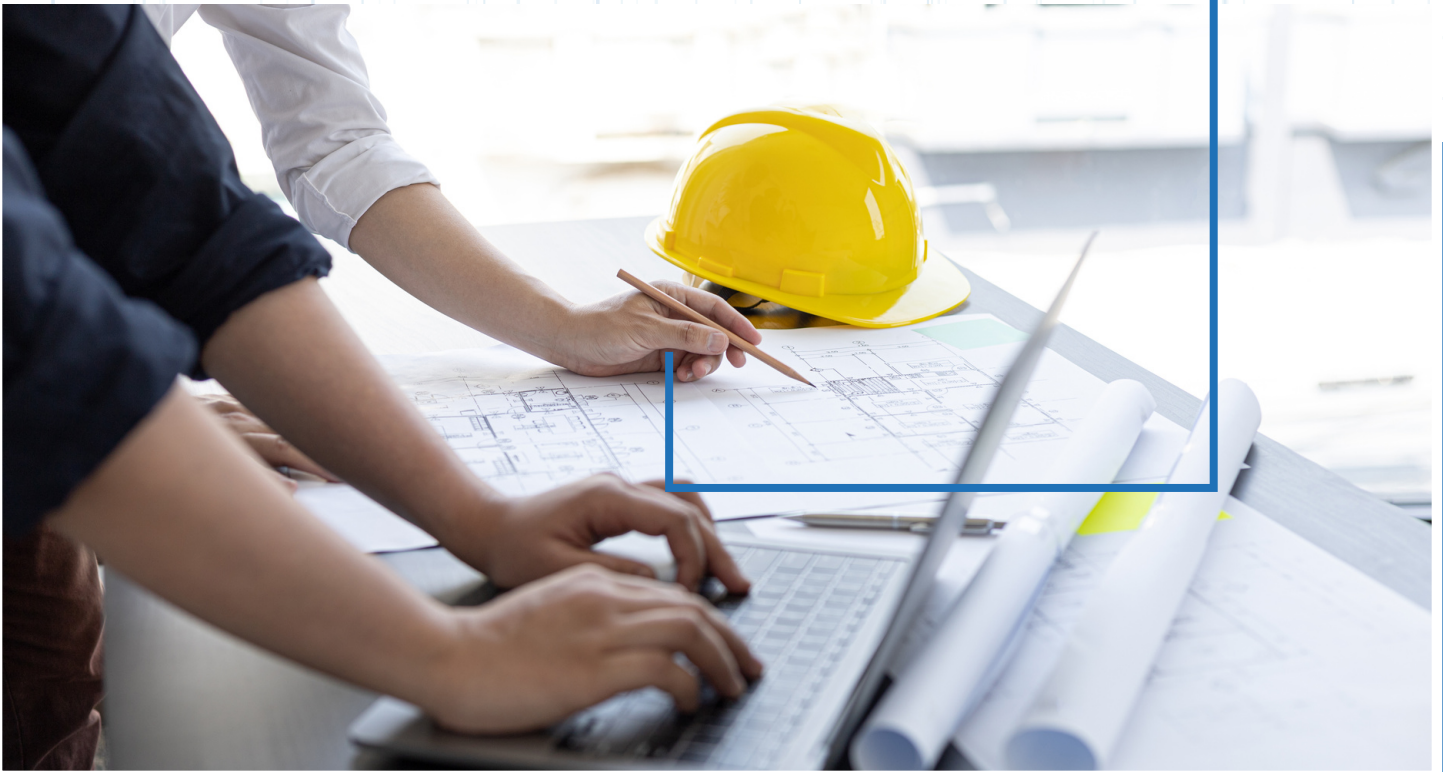

**GENUINE COMFORT**  
DELIVERING COMFORT CONSISTENTLY

Packaged Terminal Air Conditioner

Job Name:		Engineer:	
Pruchaser:		Architect:	
Unit No.:		Contractor:	
Schedule:		Submitted to:	
Location:		Submitted by:	
Comment:		Date Submitted:	

## SUBMITTAL SHEET

### Genuine Comfort 42" Prestige R32 Series

Unit Size: 42"W x 16"H Wall Sleeve

### FEATURES

- Digital controls
- Slide-Out Washable & Easy-Clean Filter
- Error Code Display for easy Diagnostic
- Hand Held Remote Control (Not Included)
- 2 Indoor Fan Speeds
- Dual Motors for Quiet & Efficient Operation
- 24 Volt Wall Thermostat Control Option
- Compressor Time Delay Protection and Efficiency
- R32 Refrigerant
- Automated Room Freeze Protection (10C/50F)
- Genuine Care Warranty: 1 Year Unit Replacement (if parts and labour is not available), 6 Year Parts Replacement



### MODEL IDENTIFICATION

Example: GC42P-E09KC3-2

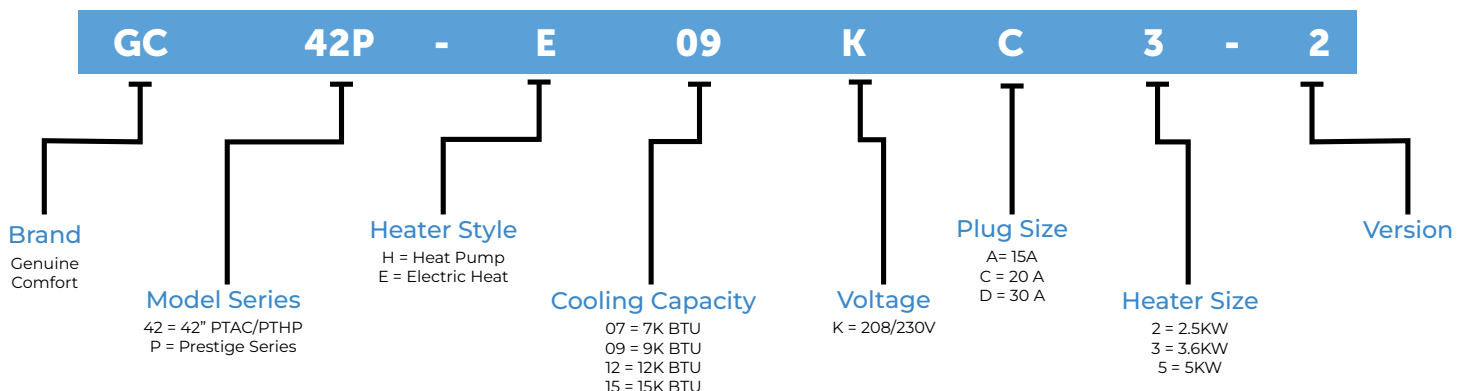

## ACCESSORIES

\*SOLD SEPARATELY



**HAND HELD  
REMOTE CONTROLLER**



**WALL SLEEVE**



**STAMPED GRILLE**



**ARCHITECTURAL  
GRILLE**



**WIRED / WIRELESS  
THERMOSTAT**



**OCCUPANCY  
SENSOR THERMOSTAT**



**EMS THERMOSTAT**



**SUB-BASE**

## DIMENSION DRAWINGS

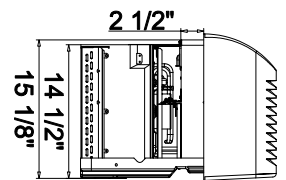
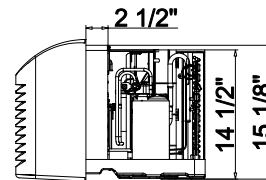
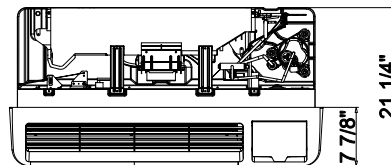
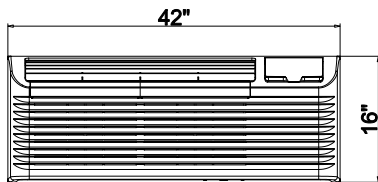

## PLUG TYPE

**TANDEM**

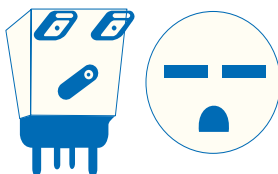

**280V/230V 15A**

**PERPENDICULAR**

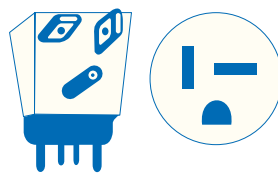

**280V/230V 20A**

**LARGE TANDEM**

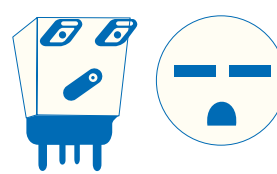

**280V/230V 30A**

## INSTALLATION INSTRUCTIONS

To ensure that the unit operates safely and efficiently, it must be installed, operated and maintained according to these installation and operating instructions and all local codes and ordinances or, in their absence, with the latest edition of the National Electric Code. The proper installation of this unit is described in the following sections. Following the steps in the order presented should ensure proper installation.

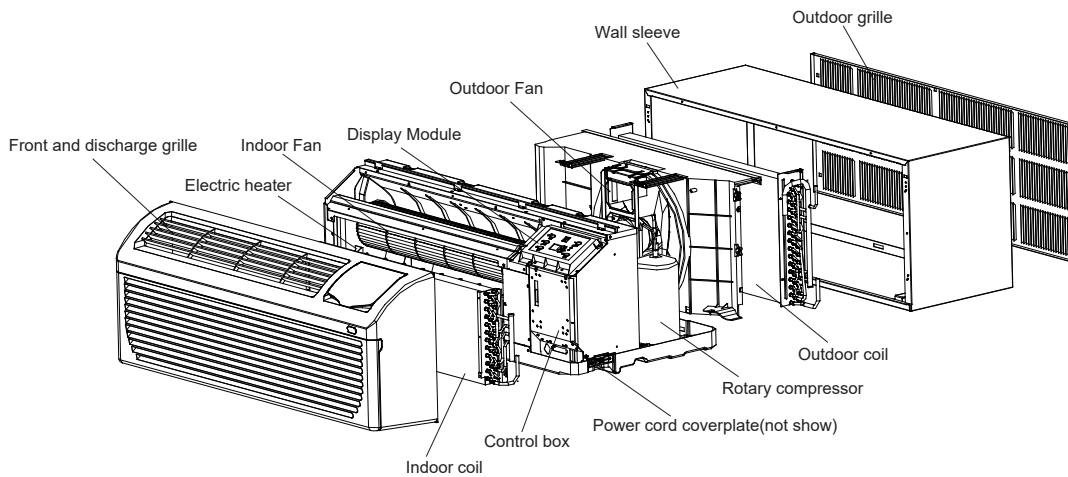

### Warning High Voltage

Disconnect all power before servicing or installing this unit. Multiple power sources may be present, failure to do so may cause property damage, personal injury or death.

## WALL SLEEVE ASSEMBLY

\*(OPTIONAL ACCESSORY)

Two kinds of wall sleeve are optional for customers, one is reassemble wall sleeve and the other one is welding integrated wall sleeve.

### Removable Wall Sleeve

The removable wall sleeve can be removed and occupies less space and is convenient to transport. Follow the below steps to install:

- Unpack all parts and accessories, referring to Fig 1.
- Assemble the wall sleeve by first "clip locking" the side pieces to the bottom piece.
- Assemble the top piece to the assembled side and top piece.

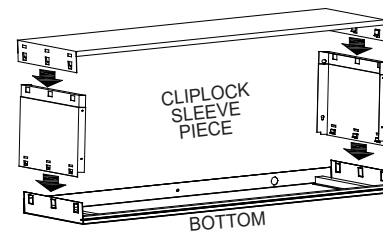

Fig 1

### Welded integrated wall sleeve

Welded integrated wall sleeve is featured by artistic appearance and stable structure referring to Fig 2.

Customers can purchase together with unit. If the wall covers are not purchased together, the user must purchase a wall cover that meets the G90 standard or salt spray test.

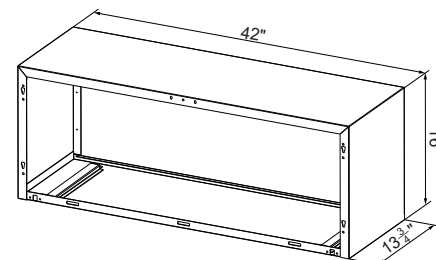

Fig 2

## SLEEVE INSTALLATION

### Wall sleeve location

When making the wall opening, please observe the following requirement:

- The air inlet and outlet should be unblocked and the air can be delivered to every corner of the room.
- Install the unit in places that are away from heat source or sources of flammable gases.
- Do not install the unit in places that are subject to strong dust.
- Do not install the unit in places where the operational noise and exhausted air might trouble your neighbour.
- There should be sufficient space margins around the unit to facilitate maintenance and repairs (refer to Figs 3 and 4).

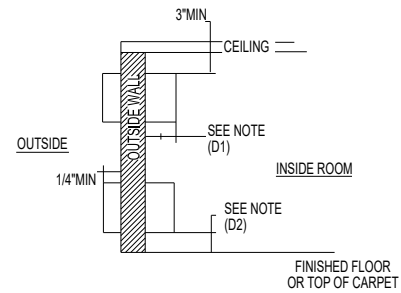

Fig 3

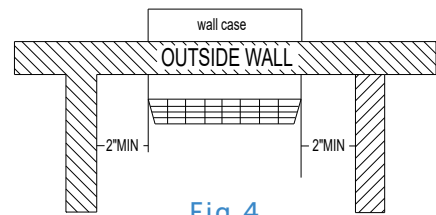

Fig 4

### Chart 1

Dimensions	Recommended installation clearance
D1	Projection of case into room-1/2" minimum up to 1-3/4" maximum without use of electrical sub-base. <i>Note: 2-3/8" minimum when sub-base is used.</i>
D2	Height above finished floor or top of carpet-1/2" minimum, 2" recommended without sub-base-3" minimum with sub-base.

### Preparation of the wall

The sleeve should be installed during construction and lintels should be used to support the block above the wall sleeve. The sleeve can not support the load of bricks/ blocks.

For existing construction, wall opening must be created, the proper dimensions are necessary to avoid use of fillers or additional framing. The sleeve is modular in height and width (refer to Fig 5 & Chart 2).

### Height:

- Fits 2 courses concrete block
- Fits 6 courses standard brick
- Fits 5 courses jumbo brick

### Width:

- Fit approximately 3 stud spaces.

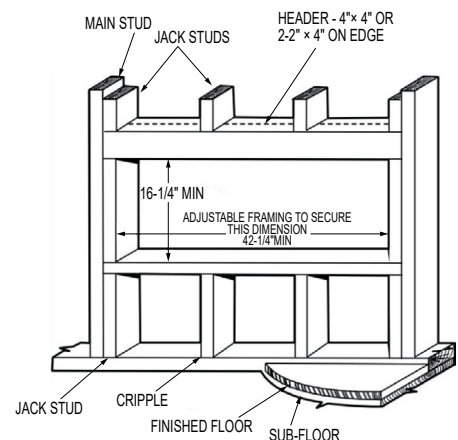

Fig 5

Chart 2

	Minium Finished Opening Dimensions		Sleeve Dimensions		
	Height	Width	Height	Width	depth
NO.1	16-1/4"	42-1/2"	16"	42"	13-3/4" (16"/18"/24")
NO.2	16-1/4"	42-1/4"			

Note:

NO.1 means using field supplied sleeve angles.

NO.2 means not using field supplied sleeve angles.

In order for condensate water to drain properly inside the unit, the sleeve must be installed properly:

- Level from right to left.
- A slight downward pitch from the indoor side to the out-door side as shown below(Fig 6).
- Fasten the wall sleeve(Fig 7).

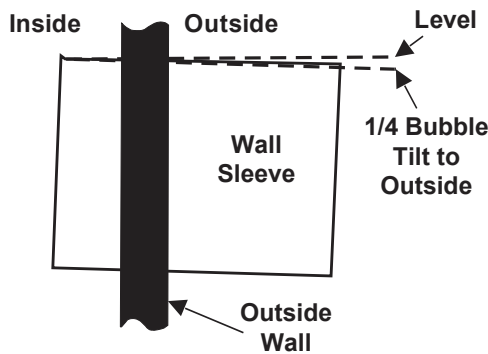

Fig 6. Proper Sleeve Tilt

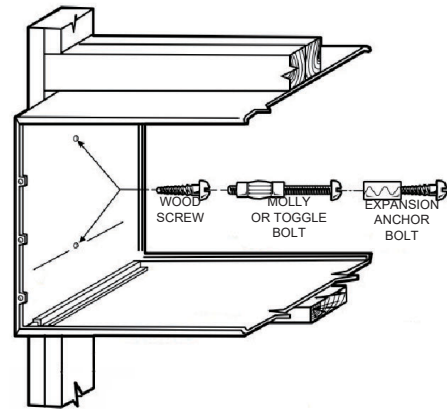

Fig 7

## OUTDOOR GRILLE

\*(OPTIONAL ACCESSORY)

An outside grille must be installed to direct air flow for proper unit operation and also protect the outdoor coil. The grille must be installed before installing the chassis.

When replacing an old chassis with an existing grille or using a specialized grille in a new installation, please check with after-sales engineer of supplier to determine if the new chassis should be used with the nonstandard specialized grille. An improper outdoor grille can decrease cooling or heating capacity, increase energy usage and shorten compressor life and possibly void the warranty.

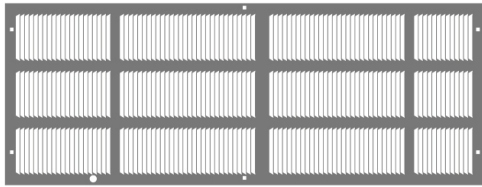

Flush Stamped Louver



Architectural Louver

## CHASSIS INSTALLATION

1. Remove the cabinet front from the chassis as described in Front Removal.
2. Insert the chassis into the wall sleeve.
3. Slide the chassis into the wall sleeve until the chassis flanges contact the front edge of the wall sleeve.
4. Secure the chassis to the wall sleeve using three screws on each side of the chassis to ensure a proper seal between the chassis and the wall sleeve. The screws are supplied in a plastic bag.

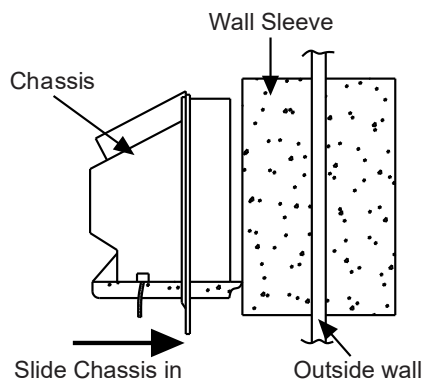

Chassis Installation View 1

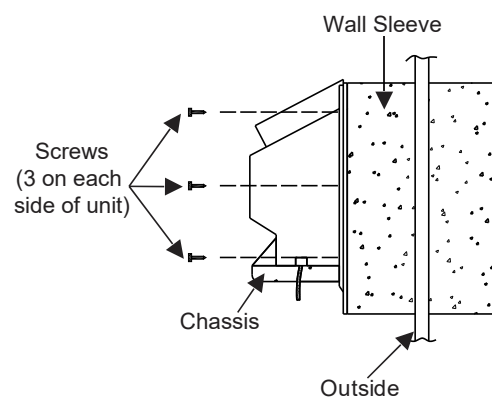

Chassis Installation View 2

## SPECIFICATIONS (ELECTRIC HEATER SIZE)

Model ID		A2	C3	D5	
Electric Heating	Electric Heater Size	KW	2.5KW	3.6KW	5.0KW
	Capacity	Btu/h	8500/6900	12000/10000	17000/13900
	Input	W	2550/2090	3650/2990	5050/4135
	Rated Current	AMPS	11.1/10.0	15.9/14.3	21.9/19.8
Max Input Consumption	VA	2565	3665	5065	
Max Current	A	11.3	16.1	22.1	
Compatible Capacity		7 / 9 / 12 / 15K		12 / 15K	
Cord Type		LCDI-15A	LCDI-20A	LCDI-30A	
Cord Length	Ft.	6.89	6.89	7	

## SPECIFICATIONS (ELECTRIC HEAT)

Model ID			GC42P-E07K_ _	GC42P-E09K_ _	GC42P-E12K_ _	GC42P-E15K_ _
Power Supply	Voltage (1 Ph., 60Hz)	V	208/230V	208/230V	208/230V	208/230V
	Capacity	Btu/h	7000/7200	9100/9300	11800/12000	14300/14500
Cooling	Input	W	580/600	785/800	1090/1110	1430/1450
		EER	12.0/12.0	11.6/11.6	10.8/10.8	10.0/10.0
Indoor Air Flow (L/M/H)	CFM		365 / 424	365 / 412	412 / 471	412 / 471
Outdoor Fresh Air	CFM		45	45	45	45
Indoor Sound Level (L/M/H)	dB(a)		38 / 47	38 / 47	46 / 52	48 / 52
Outdoor Sound Level (L/M/H)	dB(a)		66	66	66	66
Unit Dimensions (W x D x H)	inch		42 x 21 x 16	42 x 21 x 16	42 x 21 x 16	42 x 21 x 16
Package Dimension (W x D x H)	inch		45 x 25 x 19	45 x 25 x 19	45 x 25 x 19	45 x 25 x 19
Net/Gross Weight	lbs.		91/102	93/105	106/117	107/118
Refrigerant Type			R32	R32	R32	R32
Operation Temperature (Indoor)	C		16 - 32	16 - 32	16 - 32	16 - 32
	F		61 - 90	61 - 90	61 - 90	61 - 90
Ambient Temperature (Outdoor)	C		12 - 48	12 - 48	12 - 48	12 - 48
	F		53.6 - 118	53.6 - 118	53.6 - 118	53.6 - 118

## SPECIFICATIONS (HEAT PUMP)

Model ID			GC42P-H07K_ _	GC42P-H09K_ _	GC42P-H12K_ _	GC42P-H15K_ _
Power Supply	Voltage (1 Ph., 60Hz)	V	208/230V	208/230V	208/230V	208/230V
	Capacity	Btu/h	6800/7200	9000/9200	11800/12000	14300/14500
Cooling	Input	W	570/605	790/805	1110/1130	1430/1450
		EER	11.9/11.9	11.4/11.4	10.6/10.6	10.0/10.0
	Capacity	Btu/h	5800/6000	7800/8000	10200/10400	13200/13600
Heating	Input	W	485/500	670/690	880/895	1210/1245
		COP	3.5/3.5	3.4/3.4	3.4/3.4	3.2/3.2
Indoor Air Flow (L/M/H)	CFM		365 / 424	365 / 412	412 / 471	412 / 471
Outdoor Fresh Air	CFM		45	45	55	55
Indoor Sound Level (L/M/H)	dB(a)		38 / 47	38 / 47	46 / 52	48 / 52
Outdoor Sound Level (L/M/H)	dB(a)		66	66	66	66
Unit Dimensions (W x D x H)	inch		42 x 21 x 16	42 x 21 x 16	42 x 21 x 16	42 x 21 x 16
Package Dimension (W x D x H)	inch		45 x 25 x 19	45 x 25 x 19	45 x 25 x 19	45 x 25 x 19
Net/Gross Weight	lbs.		93/104	95/106	107/118	108/119
Refrigerant Type			R32	R32	R32	R32
Operation Temperature (Indoor)	C		16 - 32	16 - 32	16 - 32	16 - 32
	F		61 - 90	61 - 90	61 - 90	61 - 90
Ambient Temperature (Outdoor)	C (Cooling)		12 - 48	12 - 48	12 - 46.1	12 - 46.1
	F (Cooling)		53.6 - 118	53.6 - 118	53.6 - 115	53.6 - 115
	C (Heating)		5 - 27	5 - 27	5 - 27	5 - 27
	F (Heating)		41 - 80.6	41 - 80.6	41 - 80.6	41 - 80.6

Manufacturer reserves the right to change specifications. Our products are subject to continuous improvements. Genuine Comfort reserves the right to modify product design and specifications, discontinue design without notice and without incurring any obligations. Warranty limited to Canada and USA. See warranty documentation for full details.